

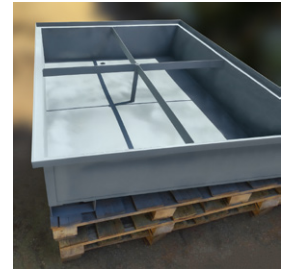

# OIL SUMP TRAY

The Oil-Collecting Tray with a Grid serves as a stand for barrels and containers, designed to localize spills of petroleum products and technical fluids. The integrated grid prevents spills from spreading onto the floor, while the tray is equipped with protective doors and hatches on the sides and top for easy access.

The tray is ideal for the temporary storage of oil products in containers and barrels, preventing leaks and spills onto hard surfaces in industrial settings, warehouses, and other facilities.



## KEY FEATURES:

- + **Durable Construction:** Made from high-quality metal coated with polymer paint and varnish for protection against oil products, UV light, and chemicals.
- + **Removable Grid:** Allows for easy cleanup and access in the event of spills.
- + **Spill Containment:** Prevents oil and technical fluids from contaminating work areas, enhancing safety and cleanliness.
- + **Protective Doors and Hatches (only for the type OST 2B):** Equipped with side and top access points for convenient operation.

This oil-collecting tray is a practical solution for ensuring the safe and effective containment of oil products, protecting workspaces from spills and environmental hazards. The permissible temperature range for the storage and operation of the pallet is from -30°C to +60°C.





# OIL SUMP TRAY



Removable grill



## Oil sump tray OST 2

Characteristics	Oil sump tray OST 2
Tray/Grate Material	Metal
Grille	Removable
Color	Blue
Coating	Polymer chemical resistant paint
Quantity, items.	1
Volume, m <sup>3</sup>	1.15
Overall dimensions in working condition, mm	1550x1550x720
Operating volume of the tank, l	1000
Metal legs, pcs.	4
Additional equipment	Drain nozzle (mouth) with plug (plug)
Weight, kg	150
Warranty period of operation	1 year





# OIL SUMP TRAY



## Oil sump tray OST 2B

Characteristics	Oil sump tray OST 2B
Tray/Grate Material	Metal
Grille	Removable
Color	Blue
Coating	Polymer chemical resistant paint
Quantity, items.	1
Volume, m <sup>3</sup>	1.15
Overall dimensions of the pallet (w*d*h), mm	1490*990*1690
Overall dimensions in working condition (w*d*h), mm	1450x1450x2165 (dimensions taking into account the installed protective cover)
Operating volume of the tank, l	1000
Metal legs, pcs.	4
Additional equipment	Drain pipe with plug, door and two hatches.
Weight, kg	375
Warranty period of operation	1 year





# OIL SUMP TRAY

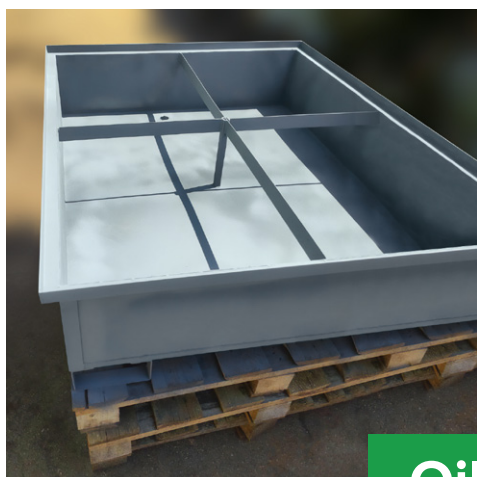

**Oil sump tray OST 1**



Characteristics	Oil sump tray OST 1
Tray/Grate Material	Metal
Grille	Removable
Color	Gray
Coating	Paint with protective coating "cold zinc"
Quantity, pcs.	1
Volume, m <sup>3</sup>	0.532
Overall dimensions (length/width/height), mm	1276x1064x392
Internal dimensions (length/width/height), mm	1000x1212x392
Operating volume of the tank, l	144
Metal legs, pcs.	4
Additional equipment	Drain nozzle (mouth) with plug (plug)
Weight, kg	54.20
Warranty period of operation	1 year

